



Recon .308 Specifications

Material: 3Al2.5V Titanium Tube with high temperature nitrided alloy steel components.

QD (Quick Disconnect) Configuration

Weight: (Suppressor only) 15.33 oz
(Including Stealth LoK™ QD System) 16.95 oz
(Including Flash Brake) 19.51 oz

Length: Suppressor with no mount 7.33 "
Including Stealth LoK™ mount 7.62"
Added length to firearm 7.19" – 7.31" (Dependent on barrel thread length)

DT (Direct Thread) Configuration

Weight: (Suppressor Only) 15.33 oz
(Including DT Coupler) 17.07 oz

Length: Suppressor with no mount 7.33"
Total Length 7.51"
Added length to firearm 6.76" – 6.88" (Dependent on barrel thread length)

The Recon .308 is a compact suppressor rated for Cartridge rounds of .308" diameter or less due to the bore size of the baffles, most notably the 7.62mmx51mm NATO cartridge. It is rated for any barrel length.

The patent pending VLB25 baffles utilize Vacuum Expansion (VE) technology which restrict the flow of gas without allowing (significantly reducing) the reverse flow of gases causing "gas blowback". The gases are compressed in the distal end of the suppressor and relieved via the endcap. This technology does not require a vented endcap so muzzle flash can remain minimized as much as possible, however vented caps are optional.

With the extreme low gas blowback this suppressor has a different tone than compared with tradition baffle suppressors. The VLB25 baffles may look like a baffle but do not behave like a classic baffle and behave very different.

The Recon suppressor comes in either a direct thread or quick disconnect configuration using the Stealth Lok™ QD system. The Stealth Lok™ QD system allows the suppressors to be rapidly installed on multiple firearms. With the 6 locking lugs and the ability to be installed in any orientation makes it quick and easy to attach in any light condition day or night and without any ratcheting mechanisms it makes it very stealthy when

connecting and disconnecting, giving the attachment device it's name. See Figure 1. for Direct thread configuration.

Figure1.

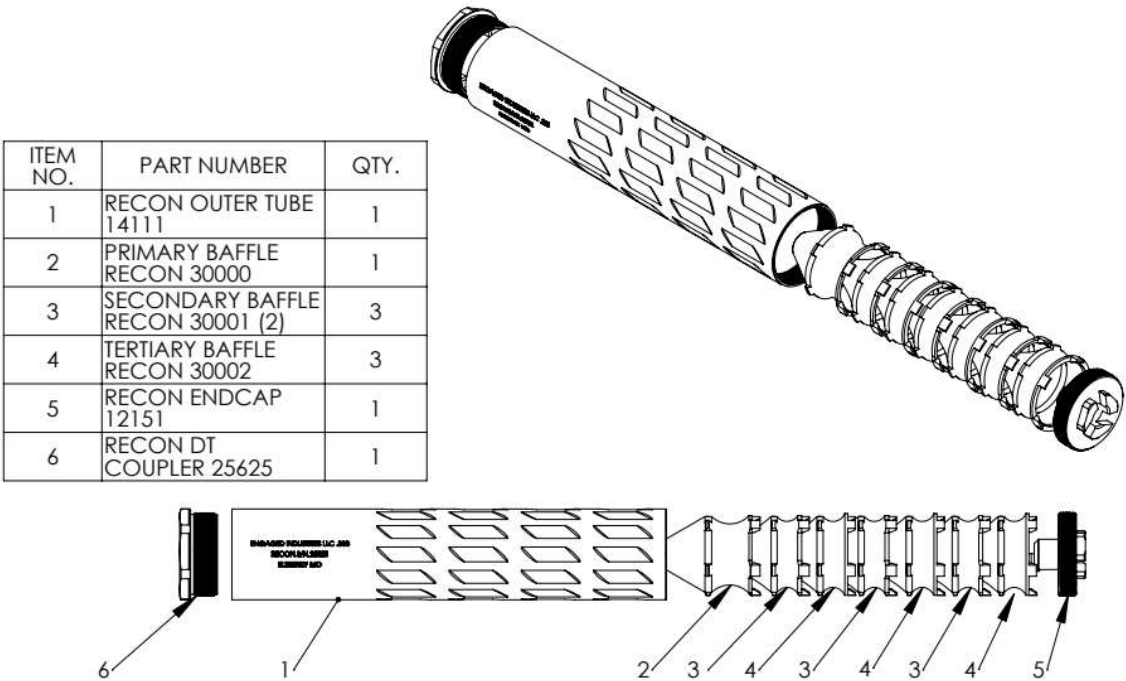

Compatibility Chart: (NOTE: Determine barrel thread and purchase thread adapter if necessary)

Cartridge	Diameter inches
.30-378 Weatherby Magnum	0.308
.300 PRC	0.308
.300 Weatherby	0.308
.300 RUM	0.308
.30 Nosler	0.308
.300 Winchester Magnum	0.308
.300 WSM	0.308
.30-06 Springfield	0.308
.308 Winchester	0.308
.300 Ruger (RCM)	0.308

.300 Blackout	0.308
.30-30 Winchester	0.308
7.62 x 39mm	0.308
.28 Nosler	0.284
7mm Weatherby	0.284
7 STW	0.284
7 WSM	0.284
7mm Rem Mag	0.284
.280 Ackley Improved	0.284
7 SAUM	0.284
.280 Remington	0.284
7mm-08 Remington	0.284
7mm Mauser	0.284
.27 Nosler	0.277
6.8 Western	0.277
.270 WSM	0.277
.270 Weatherby	0.277
.270 Winchester	0.277
6.8 Remington SPC	0.277
6.5-300 Weatherby Magnum	0.264
6.5 Weatherby RPM	0.264
6.5 PRC	0.264
.264 Winchester Magnum	0.264
6.5-284 Norma Match	0.264
.26 Nosler	0.264
.260 Remington	0.264
6.5 Creedmoor	0.264
6.5 x 55 Swedish Mauser	0.264
6.5 Grendel	0.264
.257 Weatherby	0.257
.25-06 Remington	0.257

6mm Creedmoor	0.243
.240 Weatherby	0.243
.243 Winchester	0.243
6mm Remington	0.243
6mm BR	0.243
.22 Creedmoor	0.224
.224 Valkyrie	0.224
.223 / 5.56	0.224
.22 Nosler	0.224
.22-250	0.224
.220 Swift	0.224
.222 Remington	0.224
.22 Hornet	0.224
.22 WMR	0.224
.22lr	0.223
.204 Ruger	0.204
.17 Hornet	0.172
.17 WSM	0.172
.17 HMR	0.172